

**Our door,
your signature.**

**Festa System Entrance Doors -
Technical Specifications**



FESTA
SYSTEM

Festa System Entrance Doors - Technical Specifications

Frame

Frame

Outer frame 88.5mm extruded outer frame

Insulated panel 88.5mm bonded polyurethane foam filled panel, including 3mm internal and external skin

Polyamide thermal break reinforced with glass fibre and additional polyurethane insulated chamber

Seals 3 level EPDM seal in black

Low threshold with a thermal break to enhance weather-tightness and seamless access

Maximum Sizes

Maximum height 3000mm

Maximum width 1300mm

Ventilation

Trickle vents can be included in the head section of the door (available in white, black or grey)

Cill

Cill options 22mm high at 98mm, 160mm, 200mm or 240mm wide with cill end caps included

Colour matched to the outer face order specification

Hinges

Hinges are available anodised or colour matched to the door specification

* Anodised concealed hinges are available upon request.

Performance

Thermal insulation Ud 0.72 W/m²K (without glass inserts)/ Ud 0.84 W/m²K (with glass inserts)

Air permeability (EN12207) Class 4

Watertightness (EN12208) Class 5A

Wind resistance (EN12210) Class C4/B4

Acoustic performance 44dB

Security

PAS24 Certified (tested on a single-leaf, inward-opening entrance door, manufactured to 3000mm high x 2800mm wide including a 1500mm wide sidelight)



1. Air Permeability The test sample met the requirements of the Specification

2. Watertightness The test sample met the requirements of the Specification

3. Wind Resistance The test sample met the requirements of the Specification

4. Operational Strength The test sample met the requirements of the Specification

5. Basic Security The test sample met the requirements of the Specification

Our door, your signature.

Festa System Entrance Doors - Technical Specifications

Configurations



Single door



Single door
with sidelight



Single door
with two sidelights



Single door
with toplight



Single door
with toplight
and sidelight

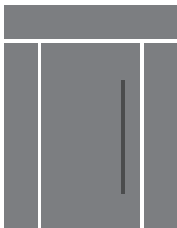

Single door
with toplight
and two
sidelights



Double door



Double door
with sidelight



Double door
with
two sidelights



Double door
with
toplight

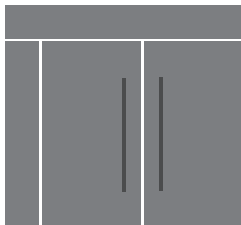

Double door
with toplight
and sidelight

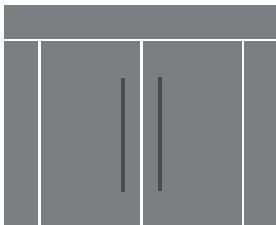

Double door
with
toplight
and two
sidelights

Festa System Entrance Doors - Technical Specifications

Glass Specification

Door Glass Inserts

Triple glazed unit 8.8mm laminated glass/ 32mm black warm edge spacer/ argon filled cavity/ 5mm float glass/ argon filled cavity/ 27mm black warm edge spacer/ 6.4mm laminated low emissivity glass

Ug value 0.6 W/m²K

Toplight/Sidelight Glass

Triple glazed unit 6.8mm laminated glass/ 24mm black warm edge spacer/ argon filled cavity/ 5mm float glass/ argon filled cavity/ 27mm black warm edge spacer/ 6.4mm laminated low emissivity glass

Ug value 0.6 W/m²K

Glass Coatings



FGL01 Clear



FGL02 Parsol Gray



FGL02 Parsol Bronze



FGL04 Stripes



FGL05 Satin

* Other coatings are available upon request

Handle Options

Stainless steel handrails and levers are available in various styles (see our brochure)

* a powder coating can be applied to match the door colour specification

* Pre-anodised and Marine Grade stainless steel is available upon request to offer improved performance in coastal/humid environments

Locking

- 01** Multi-point locking Livius Security Cylinders (FL01) as standard
 - FL02 - Automatic locking with daytime release for keyless opening
 - FL03 - Part-motorised automatic locking on all fingerprint and keypad entry systems
- 02** Internal Thumb Turn available upon request
- 03** Ekey dLine fingerprint scanner automated locking system
- 04** Ekey digital keypad automated locking system

All profile cylinders are anti-bump with "pick and drill" protection to prevent forced entry.

Festa System Entrance Doors - Technical Specifications

Frame Finishes

01 PPC in any standard RAL colour (matte, satin or gloss are available)



02 FCX (a textured/fine PPC)



03 *Pre-anodised and Marine Grade PPC available upon request

04 Stone Veneer (available to the exterior of selected models)



05 Wood Decors



06 Infinity Glass (available in black, grey, green, red, blue, yellow or white)

Festa System Entrance Doors - Technical Specifications

Entrance Door Sections

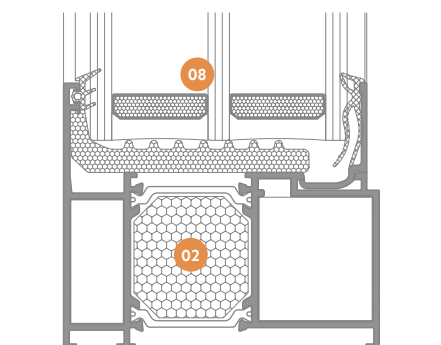
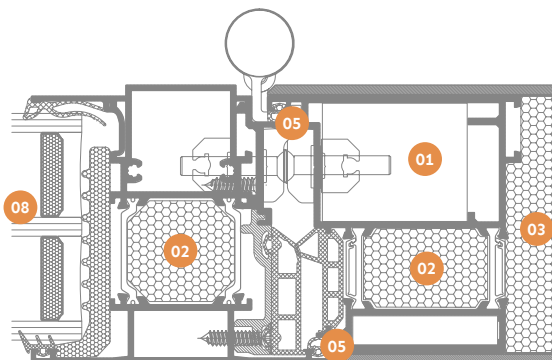
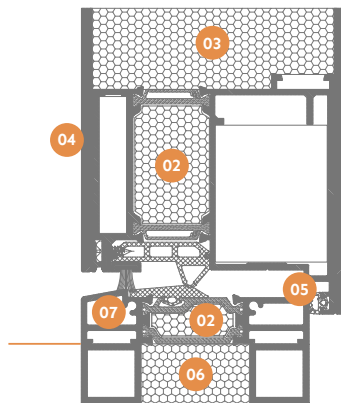
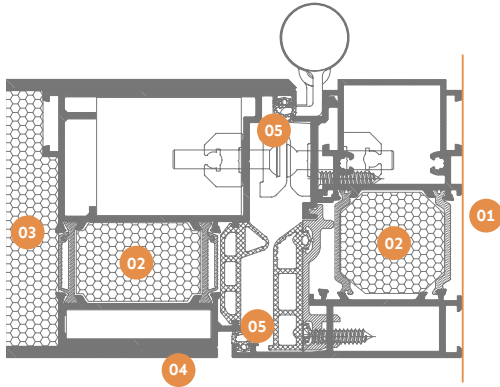

- 01** 88.5mm extruded outer frame with mechanically jointed mitred corner joints, mullions and transoms. Single framed doors have a 66.5mm sightline, doors with sidelights and top lights have a 74.5mm sightline. Mullions are 95mm, transoms are 76mm or 95mm.
- 02** Aluminium extrusions separated with polyamide thermal breaks reinforced with glass fiber and additional PU insulated chamber.
- 03** 80mm thermal insulation in door leaf.
- 04** 3mm aluminium sheet.
- 05** 3 level EPDM gaskets for optimal weather tightness.
- 06** Optional bottom add-on with thermal break.
- 07** Seamless threshold access.
- 08** Triple glazed sidelight

Festa System Entrance Doors - Technical Specifications

Speak To The Team

If you are considering a Festa System Entrance Door for your project, speak to a member of our team who will be happy to assist with your project and advise you on configurations and specification that you may not have considered for an optimal design, performance and installation.

Get A Quotation

We advise you to contact our team for a quotation. This ensures that the design and specification are within budget, and (if needed) this allows us to make adjustments to the specification to reach the desired performance, design and budgetary requirements.

Placing Your Order

When you are ready, you can place the order with us. The details of your project are then handed over to a dedicated in-house Contracts Manager who oversees the manufacture and installation phase of your project.

Your Contracts Manager will provide you with a manufacture and installation timeline and answer any questions you may have.

Please refer to our lead time document to understand the order process from initial contact through to completion.

Where Can I See This Product?

Festa Entrance Doors are available to view at the Festa System Showroom located in West Yorkshire. Simply contact us to arrange a showroom visit with one of our advisors.

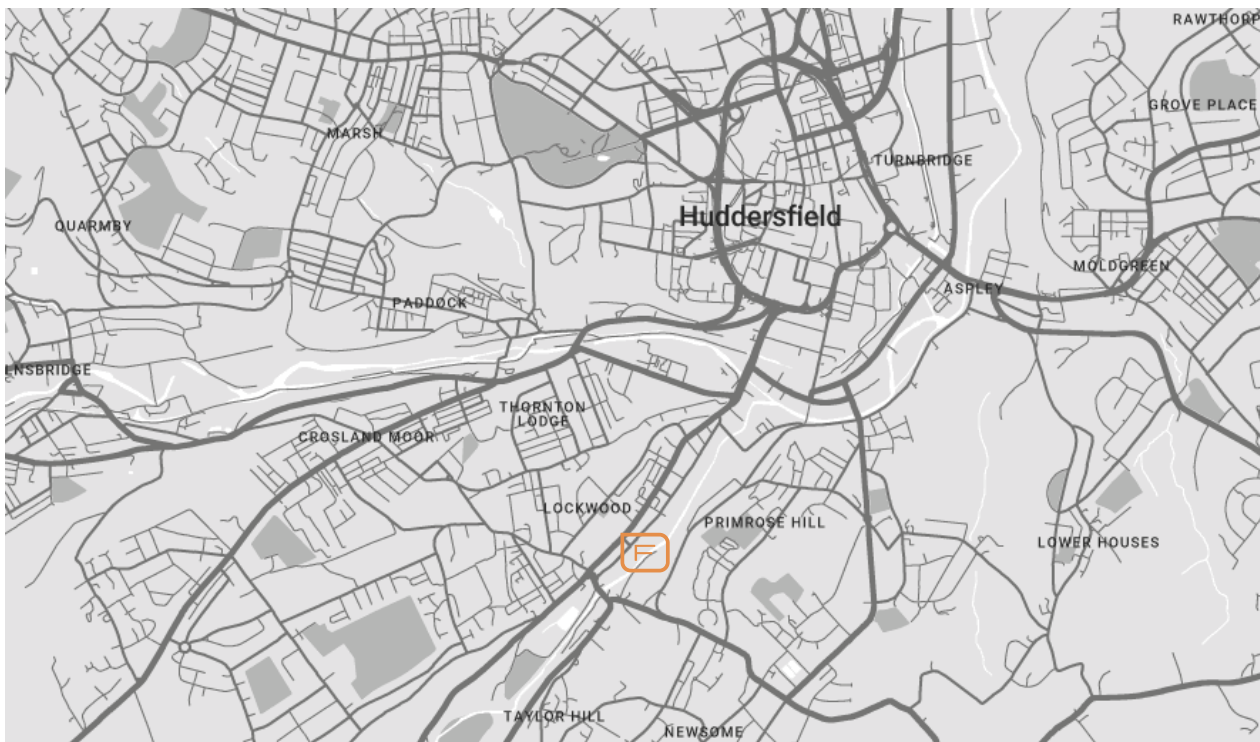

72



FESTA System UK
Unit D, The Dyeworks
Albert Street
Lockwood, Huddersfield
HD1 3RE, UK

E: info@festa-system.co.uk
T: +44 (0)1484 949 105